

PROPEL TRANSMISSION

100% COMPATIBLE WITH CAT 7495 ELECTRIC SHOVEL
N/P 82330316 / 459-5626

- ✓ INSTALLATION KIT (BOLTS, NUTS, WASHERS)
- ✓ TRANSMISSION SIDE COUPLING "INSTALLED"
- ✓ METAL DISPATCH BASE
- ✓ M42 LIFTING EYE BOLTS "INSTALLED".

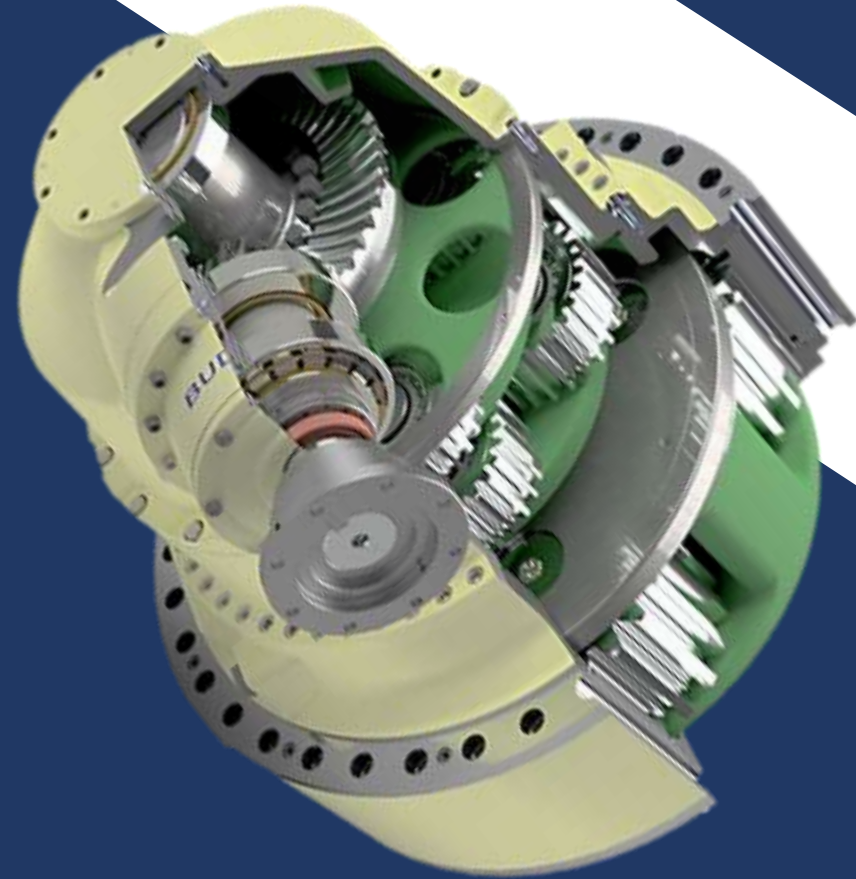

**100% COMPATIBLE WITH CAT 7495
ELECTRIC SHOVEL N/P 82330316 /
459-5626**

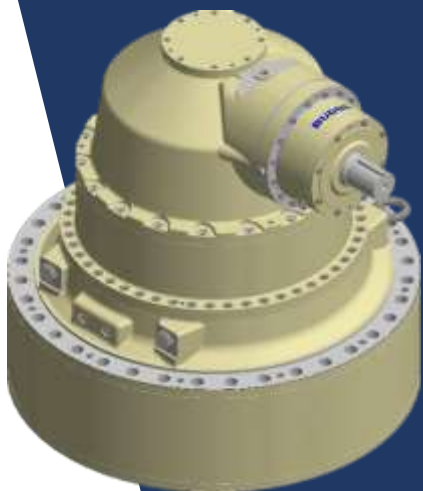

	MAX	POSITION
RPM MAX -IN-	1600	SHAFT IN-PUT
RPM MAX-OUT-	4,49	CARRIER END TX
RATIO	355,692	
PLANETARY REDUCTIONS	3	
MOTOR REQUIRED POWER	700 HP / 522 Kw	
INPUT TORQUE	6128 Nm / 4,520 ft.lbs	
OUT-PUT TORQUE	2,179,839 Nm / 1,607,764 ft.lbs	
ESTIMATED WEIGHT	7.8- TONS	

TECHNICAL DATA

